

The previous slot nut in steel, the nut 1 ESD and the previous system for nut placement and holding with a separate spring clip are being replaced.

## Nuts for retrofitting

The new nuts from mk are intended for later insertion in the profile slot if, for example, the profile abutting surface is already closed and the conventional nuts can no longer be inserted. In addition, they can also be used for profiles with polished slot that are only opened on the joint. The spring steel sheet fixed the nut, so that the assembly of attachment elements vertically is much easier.

The ESD function ensures the conductivity of the connection.

## Discontinued parts

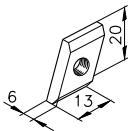

25 40 50 60 discontinued parts

**Slot Nut, Steel Zn**  
**M5 34.04.0002**  
**M6 34.04.0001**  
**M8 34.03.0001**

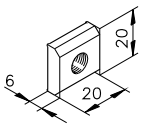

25 40 50 60 discontinued parts

**Nut 1 PE, with ESD function**  
**M6 34.02.0018**  
**M8 34.01.0018**

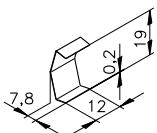

25 40 50 60 discontinued parts

**Spring Clip for Nut 1/M8,  
 M6, M5, M4, Spring Steel**  
**07.13.0002**

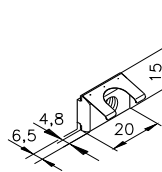

25 40 50 60

**Drop-in Nut, Steel Zn**  
 with spring steel sheet  
 with ESD function

**M4 34.16.0431**  
**M5 34.16.0531**  
**M6 34.16.0631**  
**M8 34.16.0831**