

Rotary Table DT-P 2040



Buffering.

Separating.

Storing.

Rotary Table DT-P 2040

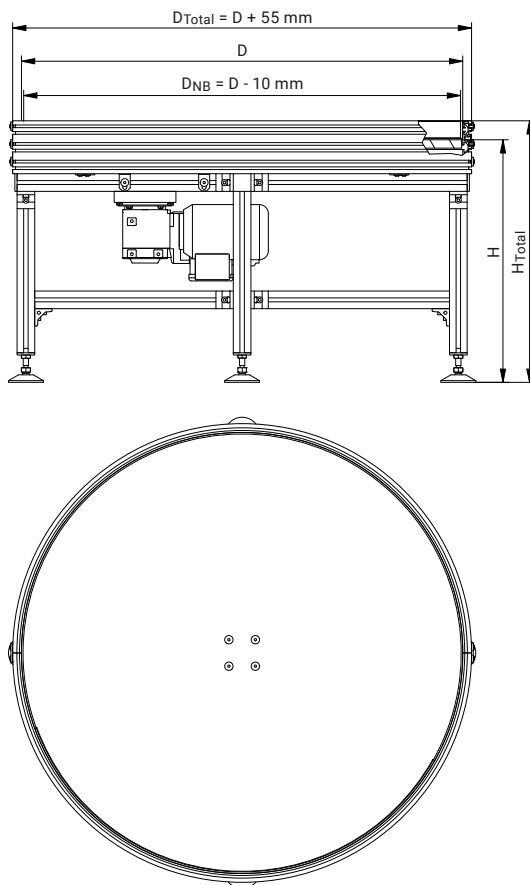

Technical data

Diameter D	750, 1000 and 1250 mm	others on request
Rotary table top	MDF, HPL, MDF with felt, HPL with stainless steel sheet	others on request
Drive version	chain	
Speed	2,6; 4,0; 6,0 U/min	others on request
Load	100 kg	
Side rails	integrated (approx. 40 mm depending on the table top material)	higher on request
Height H	500-1500 mm	others on request

Table Tops

The following table top materials are available.

MDF

Medium-density fibreboard as the cheapest option.

HPL

High-density fibreboard as a more robust and moisture-resistant option.

MDF + Filz

Medium-density fibreboard with glued felt pad made of belt material GU-F0106-019SW (see Conveyor Technology Catalog) for sensitive goods.

HPL + VA-Blech

High-density fibreboard with glued stainless steel sheet as a robust and wear-resistant option for sharp-edged goods.

Infeed and Discharge Designs

For all the designs, you can choose either clockwise or anti-clockwise rotation.

When designing diverters, the weight and shape of the product being conveyed plays a major role. mk therefore creates the technical design of the diverters based on the customer's specific requirements. With extensive experience in interlinking and conveying applications, mk can draw on a wealth of previously implemented solutions. For example, we can implement adjustable diverter plates that are integrated into the control system.

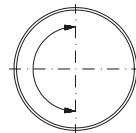

Design A (Standard)

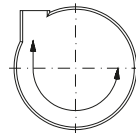

Design B (special)
Left side exit

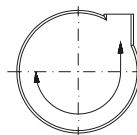

Design C (special)
Right side exit

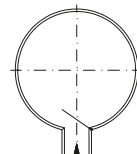

Design D (special)
Central exit

Sample order

DT-P 2040 Design A

D = 1000 mm

H = 800 mm

Table Top = MDF

v = 6 U/min anti-clockwise rotation

Customer Applications



Standard rotary table DT-P 2040
without wear strip in inner radius



Rotary table DT-P 2040 with
side rail and sheet metal cover



Rotary table DT-P 2040 with separation and
positioning using surrounding side panels



Rotary table DT-P 2040 with manually
adjustable separation of parts

Customer Applications



Standard rotary table DT-P 2040
with movable base frame



Rotary table DT-P 2040 with
side rail, similar to SF01



Rotary table DT-P 2040 with part separation
using manually adjustable direction guide



Rotary table with milled special plastic
sliding plate and feeding via belt conveyor



Maschinenbau Kitz GmbH
Headquarters of the
mk Technology Group

Ampèrestrasse 18
53844 Troisdorf, Germany
Germany

Phone +49 228 4598-0
info@mk-group.com

www.mk-group.com

